

TERMINAL BLOCK Connector

KLSelectronic
www.cnkls.com

PCB Series

KLS2-300-7.50 Series Pitch=7.50mm

Electrical :

Rated voltage: 300V
Rated current: 16A
Contact resistance: 20mΩ
Insulation resistance: 5000MΩ/1000V
Withstanding Voltage: AC1500V/1Min
Wire range: 22-14AWG 2.5mm²

Material

Screws: M3 steel Zinc plated
Wire guard: phosphor bronze Ni plated or stainless steel
Pin header: Brass, Tin plated
Housing: PBT,UL94V-0

Mechanical

Temp. Range: -30°C~+120°C
MAX Soldering: +250°C for 5 Sec.
Torque: 0.5Nm (4.5lb.in)
Strip length: 4.5-5mm

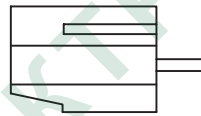
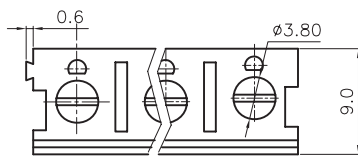

N=Number of contacts

STRAIGHT TYPE

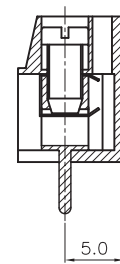
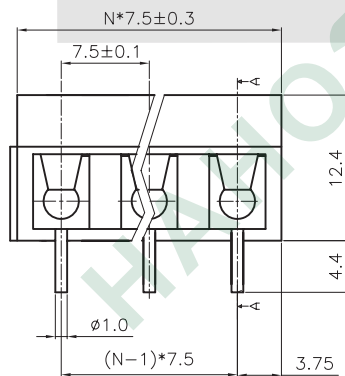

SECTION A-A

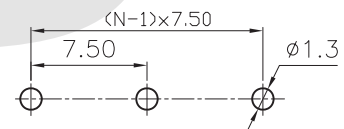

P.C.B. LAYOUT

ORDER INFORMATION

Product NO.: KLS2-300-7.50-XXP X X X

Pos. NO.

Series No.

Pitch: 7.50=7.50mm

Number of Pole

Customer Request

Screw: C=Cross Screw
S=Slot Screw

Color: 1=Gray 2=Blue 3=Black
4=Green 5=Orange 6=Red
7=Transparent 8=Yellow 9=White

All specification & dimensions are subject to change, please call your nearest KLS sales representative for update information